

TECHNICAL DATA

- » Maximum glazing thickness 44 mm
- » Opening possibilities
Open outwards - Practicable in English project standards
- » Sections
Frame – 70 mm / Sash – 70 mm
- » Profile thickness
Window 1,6 mm
- » Polyamide strip length
from 32mm



»Maximum dimensions / sheet

Reduced sheet

Practicable
Width (L) = 700 mm
High (H) = 1,300 mm

Projecting
Width (L) = 1,200 mm
High (H) = 1,300 mm

Large loads sheet

Practicable
Width (L) = 750 mm
High (H) = 1,750 mm

Projecting
Width (L) = 1,800 mm
Height (H) = 1,800 mm

»Maximum weight / sheet

Reduced
Practicable 35 Kg
Projecting 50 Kg

HD
Practicable 42 Kg
Projecting 100 Kg



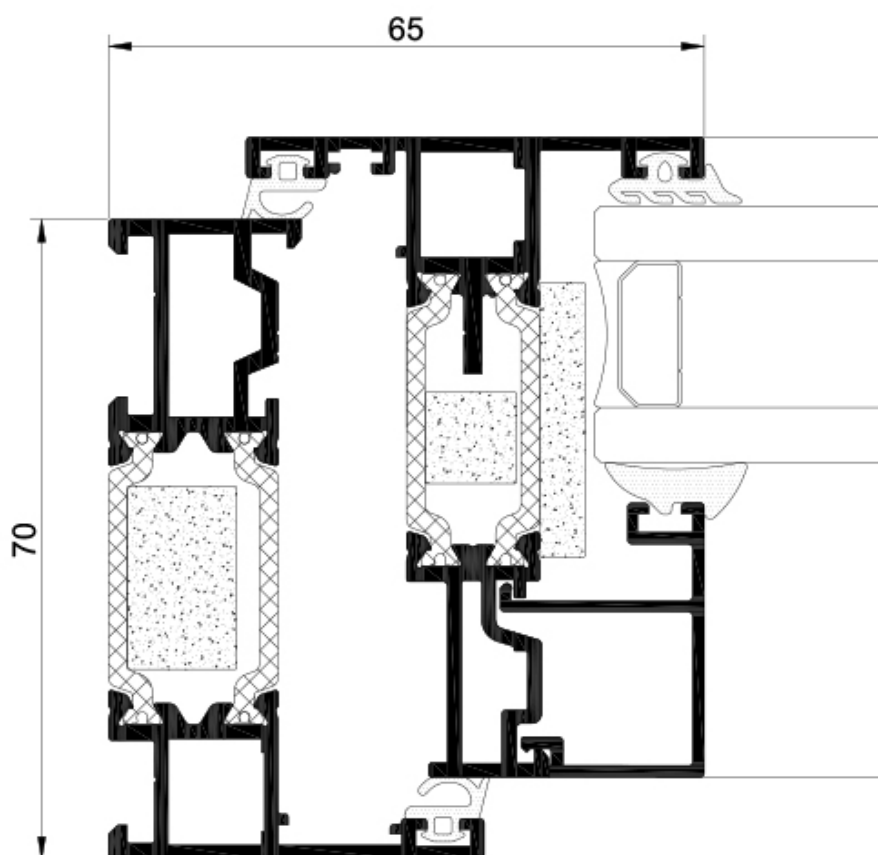

TEST CENTRE

» Transmittance

Uw from 0,9 (W/m²K)

Please consult typology, dimensions and glazing

» Maximum acoustic insulation

Rw=44 dB

» Air permeability

(EN 12207:2000) CLASS 4

» Water tightness

(EN 12208:2000) CLASS E1200

» Wind resistance

(EN 12210:2000) CLASS C5

Reference test 1,23 x 1,48 m.

2 Sashes window.

» Burglar resistant

(EN 1627:2011): Grade RC2 (WK2)

Reference test 2,52 x 1,47 m. 1 sash
with EVO SECURITY hardware

Please consult regarding maximum weight and dimensions according to types:

- » Finishes
- » Possibility of bicolor systems
- » Color powder coating (RAL, mottled and rough)
- » Wood effect powder coating
- » Anti-bacterial powder coating
- » Anodized

