

DESCRIPTION

The new W50TB thermal barrier steel window system was developed to provide architects and planners with optimal solutions for projects involving the renovation or restoration of industrial heritage buildings. In addition, this profile series provides interesting stimuli for design-oriented contemporary architecture.

The characteristic profile contour – 5.5 mm recess in the sightline – emphasises both the delicate appearance and the link to historical hot-rolled steel profiles. Furthermore, these unique profile contours ensure that the glazing is always flush, in same line between the fixed section and the window section.

The wide range of profiles – with installation depths of 50 mm and 55.5 mm and sightline widths of 32 mm for the frame profile and 57.5 mm for the frame/sash combination – makes it possible to create large-format windows, doors and facade bands with any type of opening. The opening and design variants are typical of Bauhaus architecture but are also in line with contemporary style and aesthetics. The innovative profile connection, the thermal barrier, guarantees optimal thermal and acoustic insulation in conjunction with functional insulating glass.



TECHNICAL DATA

1. Precision cold formed steel profiles
2. "Stepped leg" design
3. High density cast in polyurethane isolator
4. Very compact profiles with minimal depth and sightlines
5. Mechanically fixed non-shrinking gaskets
6. Low emissivity double-glazing up to 37 mm
7. Choice of different glazing beads
8. Zinc-magnesium pre-coating for corrosion protection

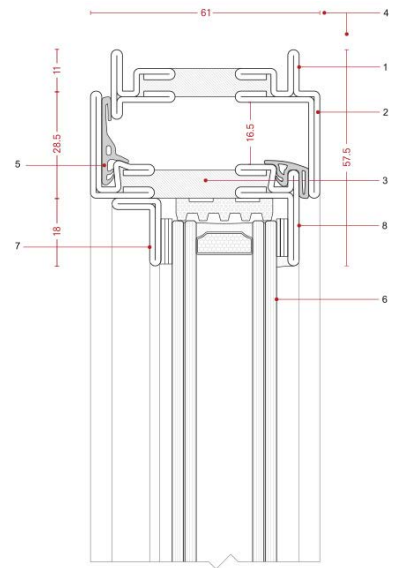

GLAZING

All our Modern W50TB windows are internally beaded for enhanced security

All windows can have up to 37mm double glazed unit with a U-value 1,0W/m²K and in standard comes with low emission coating





Within required by Building Regulation areas included is safety glazing

We also offer additionally ranges of coloured, toughened, laminated glass for extra security. Some other available glass options:

- Tripleglazed units for sound reduction and energy efficiency
- Acoustic
- Solar control
- Self cleaning
- Digital print units
- Ornamental

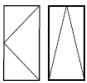
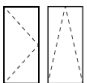
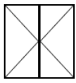
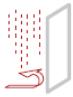

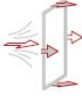
TEST CENTRE

Norm	Test			
		Inward opening	Outward opening	Inward opening
EN12208 	Watertightness	up to Class 7B - 300 Pa	up to Class 9A - 600 Pa	up to Class 7B - 300 Pa
EN12210 	Resistance to wind load	up to Class C3 - 1200 Pa	up to Class C5 - 2000 Pa	up to Class C3 - 1200 Pa
EN12207 	Air permeability	up to Class C4 - 600 Pa	up to Class C4 - 600 Pa	up to Class C4 - 600 Pa
ENISO10077-1 	Heat transfer coefficient	from > 1,50 W/m²K	from > 1,50 W/m²K	from > 1,50 W/m²K

